

Stuart Steel Protection Corporation, Box 476, South Bound Brook, NJ 08880 • Telephone (732) 469-5544 • FAX (732) 469-9270  
 Website: www.stusteel.com E-mail: sspcmail@worldnet.att.net

## COMPRESSION CRIMPETS

### TYPE YC-C COPPER CRIMPIT

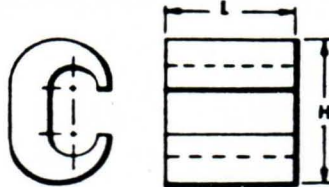

Type YC-C copper crimpit connector is a range-taking C shape compression connector for making tap or parallel copper connections from #12 sol to 4/0 strand conductors.



CATALOG NUMBER	WIRE RANGE		L	INSTALLATION TOOLING ■					STRIP LENGTH
	RUN	TAP		TOOLS, DIESETS, NO. OF CRIMPS ‡					
				DIE INDEX	HYTOOL MD6	‡	HYPRESS Y35, Y39	‡	
YC10C10*	12 sol. - 10 str.	12 sol. - 10 str.	¾"	238	W238	1	—	—	½"
YC8C8	8 sol. - 8 str.	10 sol. - 8 str.	½"	162	W162	2	—	—	¾"
YC4C8	6 sol. - 4 str.	8 sol. - 8 str.	¾"	BG	W-BG	1	U-BG	1	¾"
YC4C6		6 sol. - 6 str.							
YC4C4		4 sol. - 4 str.							
YC2C4	2 sol. - 2 str.	8 sol. - 4 str.	¾"	C	W-C	2	U-C	1	1"
YC2C2		2 sol. - 2 str.							
YC26C2	1/0 str. - 2/0 str.	8 sol. - 2 str.	1"	0	—	—	U-0	1	1½"
YC26C26		1/0 str. - 2/0 str.							
YC26C2	3/0 str. 4/0 str.	6 sol. - 2 str.	1½"	D <sub>3</sub>	—	—	U-D <sub>3</sub>	1	1½"
YC26C26		1/0 str. - 2/0 str.							
YC26C28		3/0 str. - 4/0 str.							

\* Not UL Listed

‡ Number of Crimps

■ See tooling sections of this catalog for complete tool and die listings.

## TYPE Y35 HYPRESS HAND OPERATED HYDRAULIC TOOL

Hook-shaped, rotatable head and "shell" designed U-dies provide extensive ram travel for installing wide range of connectors. Ram advance handle permits installer to grip connectors in tool and slip over conductor prior to crimping. Ram retraction controlled by trigger located at lever hand grip. Neoprene insulated, except for head. Supplied with steel carrying case. Dies ordered separately.



TOOL SPECIFICATIONS	Y35
Force Developed	12 tons
Weight Less Case	13 lbs.
Maximum Width	6"
Maximum Height	24"

## TYPES KS & KS-3 SERVIT® For Copper, Copperweld

Compact, high strength, high copper alloy SERVIT split-bolt has free-running threads, and easy to grip wrench flats. Highly resistant to season cracking and corrosion, the SERVIT provides maximum pressure and assures secure connection on all combinations of run and tap conductors. Type KS-3, similar to Type KS, accommodates 3 maximum size conductors.



CATALOG NUMBER	CONDUCTOR					
	COPPER		COOPERWELD			
	RANGE FOR EQUAL RUN AND TAP	MIN. TAP WITH MAX. RUN	MAXIMUM			
SOL.			STR.	TYPE A	TYPE D	
KS90*	12 STR.-10 STR.	16 STR.	#10	—	—	—
KS15	10 STR.-8 STR.	14 STR.	#8	—	—	—
KS17	8 STR.-6 SOL.	14 STR.	#6	3 #12	8A	9½D
KS17-3*	8 STR.-6 SOL.	14 STR.	#6	3 #12	8A	9½D
KS20	8 STR.-4 SOL.	14 STR.	#4	3 #10	6A	8D
KS20-3*	8 STR.-4 SOL.	14 STR.	#4	3 #10	6A	8D
KS22	6 STR.-2 SOL.	14 STR.	#2	3 #8	4A	6D
KS22-3*	6 STR.-2 SOL.	14 STR.	#2	3 #8	4A	6D
KS23	6 STR.-2 STR.	14 STR.	#1	3 #7	3A	5D
KS25	4 STR.-1/0 STR.	14 STR.	2/0	3 #5	2A	4D
KS26	2 STR.-2/0 STR.	14 STR.	3/0	7 #7	—	—
KS27	1 STR.-3/0 STR.	8 SOL.	—	—	—	—
KS29	1 STR.-250	8 STR.	4/0	7 #5	—	—
KS31	1/0 STR.-350	1/0 STR.	—	19 #8	—	—
KS34	2/0 STR.-500	2/0 STR.	—	19 #6	—	—
KS39	4/0 STR.-750	4/0 STR.	—	19 #5	—	—
KS44	300-1000	4/0 STR.	—	—	—	—

\*Not UL Listed